	<b>Offshore Design Section Engineering Services ISO – 9001:2008</b>	<b>DATA SHEET FOR SUBSEA FLOW TEE (SOUR SERVICE) DS no: 2028B-DS-TEE-PRP-VII- RTR</b>	<b>Spec. No.</b>	<b>2028B-DS- TEE-PRP- VII-RTR</b>
			<b>Rev. No.</b>	<b>0</b>
			<b>Discipline</b>	<b>Pipeline</b>
			<b>Page: 1 OF 3</b>	

1. **Manufacturer** :
2. **Company Specification No.** : 2028B
3. **Design/Service Conditions:**

Design Pressure : Refer Process Design Criteria

Design Temp. : Refer Process Design Criteria

Design Code : ASME 31.8/ ASME 31.4 / Boiler & Pressure  
Vessel Code

Service : Well Fluid (Sour) / Gas Lift (Sour)

Corrosion Allowance : 6.0 mm

ANSI Rating : 1500

Installation water depth : 100 m
4. **Pipeline Details:**

Size (Nominal) : 8"

Thickness : As per design by the Contractor (for Zone-2 pipe)

Material : API 5L Gr X60 (NACE)
5. **Material Specification (or Equivalent/Superior)**

Tee : ASTM A 694 Gr F-60 NACE

End piece/rings : ASTM A 694 Gr F-60 NACE

Internal Pipe : API 5L Gr X-60 (NACE) (Pipeline material)

FORMAT No.	Ref. PROCEDURE No.	ISSUE No.	REV. No.	REV. DATE:
ODS/SOF/004	ODS/SOP/023	01	00	21.07.2010

	<b>Offshore Design Section Engineering Services ISO – 9001:2008</b>	<b>DATA SHEET FOR SUBSEA FLOW TEE (SOUR SERVICE) DS no: 2028B-DS-TEE-PRP-VII- RTR</b>	<b>Spec. No.</b>	<b>2028B-DS- TEE-PRP- VII-RTR</b>
			<b>Rev. No.</b>	<b>0</b>
			<b>Discipline</b>	<b>Pipeline</b>
			<b>Page: 2 OF 3</b>	

**6. Flow Tee Details:**

Size : 8" X 4.5" X 8"

Qty. : 8" X 4.5" X 8" class 1500# - Four number

Wall Thickness of run pipe & grade : Same as main pipeline

**7. Others:**

- a. Manufacturer to indicate the dimensions marked "A" & "B" in figure on Sheet 3 of 3 and the details of the holes in the internal pipe.  
Area of the holes on the internal pipes: Minimum 1.1 times of internal area of branch connection (Calculation shall be submitted in support of the same)

<b>SBD</b>	<b>BPM</b>	<b>AKM</b>	<b>ISSUED FOR BID</b>	<b>3</b>	<b>22/01/2021</b>
<b>PREPARED BY</b>	<b>REVIEWED BY</b>	<b>APPROVED BY</b>	<b>REMARKS</b>	<b>NO. OF PAGES</b>	<b>DATE</b>

FORMAT No.	Ref. PROCEDURE No.	ISSUE No.	REV. No.	REV. DATE:
ODS/SOF/004	ODS/SOP/023	01	00	21.07.2010



Offshore Design  
Section  
Engineering  
Services  
ISO – 9001:2008

**DATA SHEET FOR  
SUBSEA FLOW TEE  
(SOUR SERVICE)**  
DS no: 2028B-DS-TEE-PRP-VII-  
RTR

Spec. No.	2028B-DS- TEE-PRP- VII-RTR
Rev. No.	0
Discipline	Pipeline
Page: 3 OF 3	

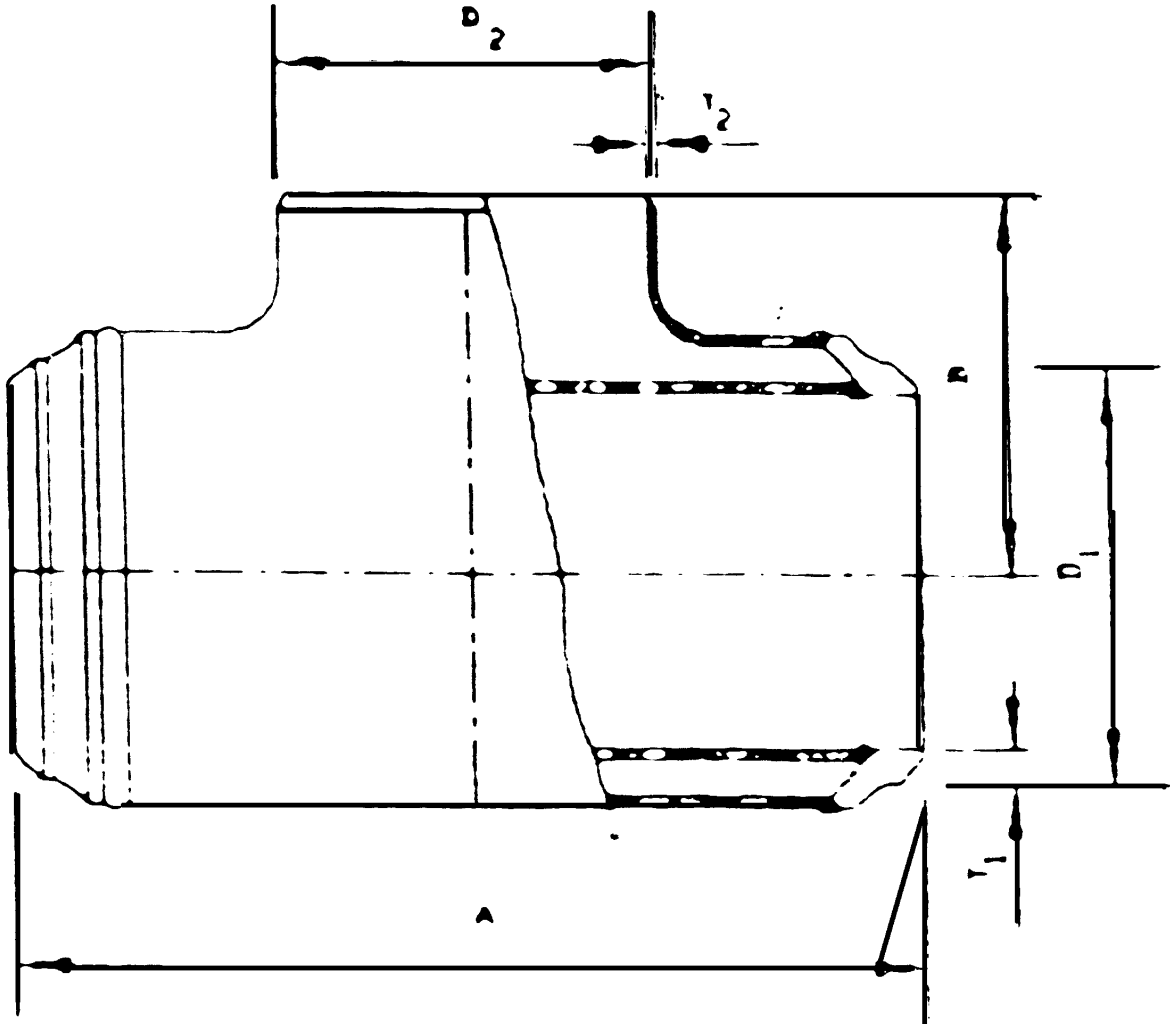

FORMAT No.	Ref. PROCEDURE No.	ISSUE No.	REV. No.	REV. DATE:
ODS/SOF/004	ODS/SOP/023	01	00	21.07.2010